

LEBANON BUILDING TRADES  
615 PEPPER DR  
LEBANON, IN

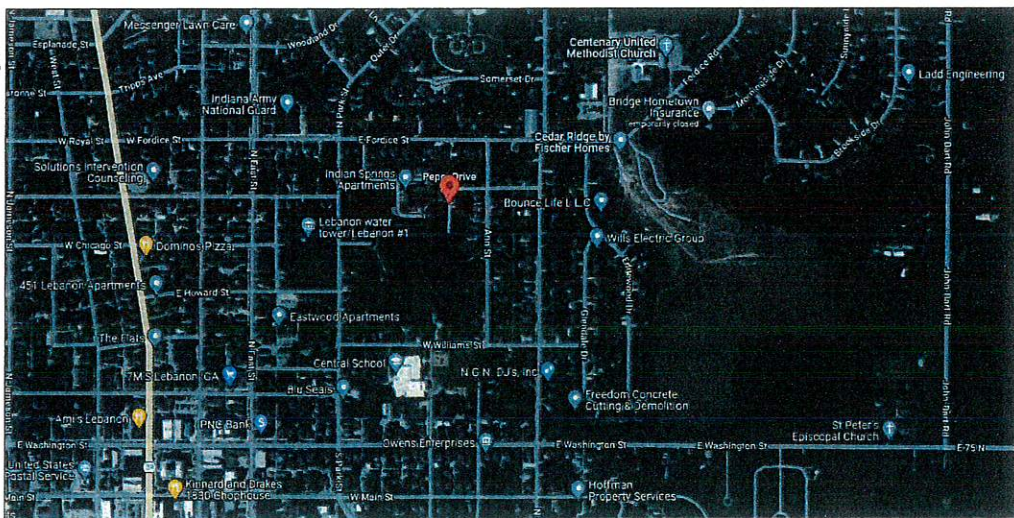

GENERAL LOCATION

SUBJECT TRACT AND DESCRIPTION:

Walnut Glen Lot 7

Flood Elevation 931.6 per 18011C0187E dated 1/18/2012

LEGEND  
AS APPLICABLE

- 5/8-inch REBAR w/ CAP STAMPED "HAUSE PLS20600040"
- ⊙ MAGNETIC NAIL w/ WASHER STAMPED "HAUSE PLS20600040"
- ⊘ UTILITY POLE
- ⊞ TELEPHONE PEDESTAL
- ⊕ WATER WELL
- ⊙ LIGHT POLE
- ⊞ AIR CONDITIONER
- ⊞ SILT FENCE
- ⊞ SUMP DRAIN
- ⊞ CLEAN OUT
- ⊞ GUY WIRE
- ⊞ ELECTRIC METER/BOX
- ⊞ CABLE PEDESTAL
- ⊞ GAS ENTRANCE
- ⊞ SANITARY MANHOLE
- ⊞ DECIDUOUS TREE
- ⊞ CONIFEROUS TREE
- (D) DEED BEARING AND DISTANCE
- (M) MEASURED BEARING AND DISTANCE
- ⊞ WATER VALVE
- ⊞ FIRE HYDRANT
- ⊞ STORM MANHOLE
- ⊞ BEEHIVE INLET
- ⊞ CURB INLET
- BOLLARD
- ⊞ SATELLITE DISH
- POST ⊞ FENCE POST
- ⊞ SITE BENCHMARK
- ⊞ MAILBOX
- ⊞ SOIL BORE LOCATION
- ⊞ VISUAL MONITORING WELL

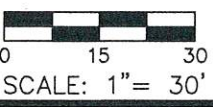

Copyright © Hause Surveying and Engineering, LLC. All rights reserved. No part of this drawing may be reproduced by photocopying, recording or by any other means, or stored, processed or transmitted in or by any computer or other systems without the prior written permission of the surveyor. Copies of this plan without a dated and blue signature are not valid.

PROJECT NO. 22H528	SHEET NO. 1 OF 2 SHEETS	PLOT PLAN - GENERAL	
		LEBANON BUILDING TRADES PT. NE 1/4, NW 1/4, SEC. 31, T19N, R1E, LEBANON, BOONE CO., IN.	

No.	Date	Revisions

DRAWN BY:  
GHP  
CHECKED BY:  
JEH  
DATE:  
8/19/2022  
SCALE:  
1"=30'

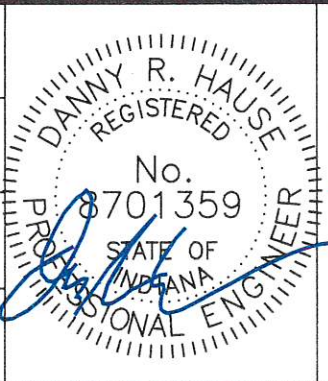

105 N. MERIDIAN ST.  
LEBANON, IN 46052  
PHONE: (765) 482-5141  
INFO@HAUSESURVEYINGANDENGINEERING.COM  
  
A SERVICE DISABLED VETERAN  
OWNED SMALL BUSINESS